

TUB FILLER WITH DIVERTER AND HAND SHOWER

Cat. No.
4023



Features:

- ▶ Code gooseneck spout
- ▶ 1/4" Turn ceramic disc cartridges
- ▶ 3-3/8" Centers
- ▶ Centers can be adjusted out to 9" with use of part #4501 (Swivel arms)
- ▶ Flow rate for faucet is 3.68 GPM
- ▶ Flow rate for handshower is 2.5 GPM
- ▶ Hand-held shower and cradle
- ▶ Check valve in handshower
- ▶ Includes 59" hose
- ▶ Includes 6" wall support
- ▶ Shower head not included
- ▶ For cast iron tub use only (Part# 4024 for acrylic tub)

Finishes:

CP Polished Chrome **BN** Brushed Nickel



W: 9"
H: 12"
D: 9-1/2"
Riser Height: 60"

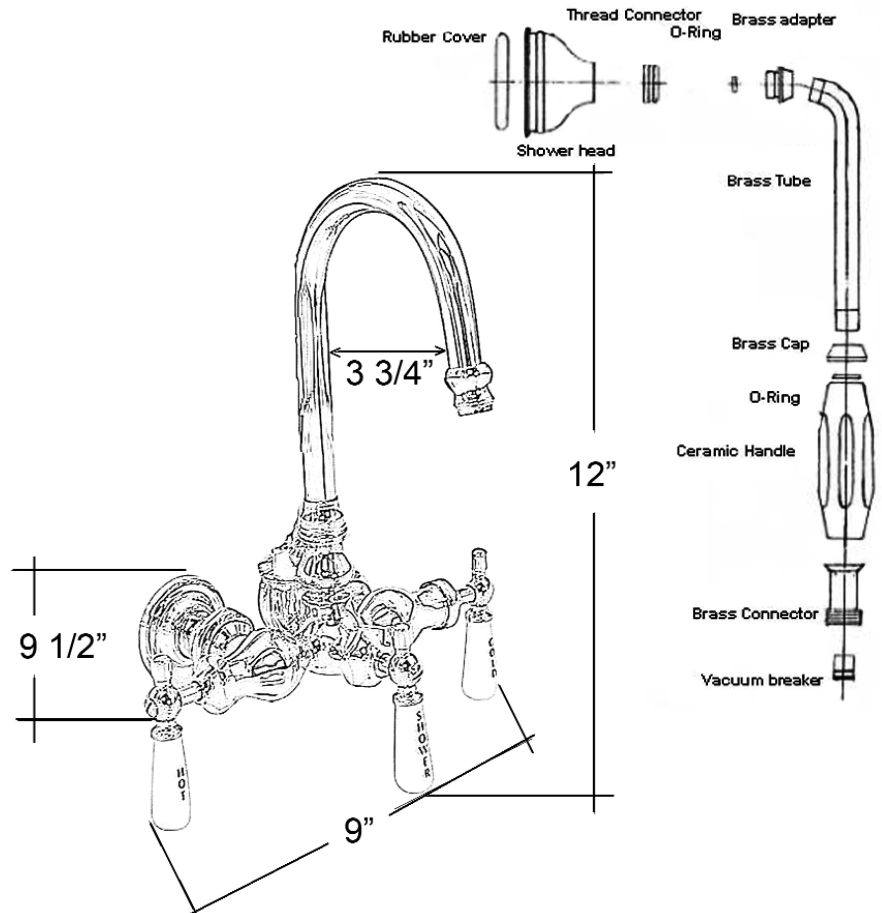

Dimensions of fixture are nominal and may vary. Dimensions and specifications subject to change without notice.